

Description

PRE-TERMINATION OF OPTICAL CABLES



Description

Laboratory pre-termination of loose fibre optic cables with dielectric armour and LSZH outer sheath for indoor use or with metallic armour with corrugated steel tube and PE sheath for outdoor use only. Pre-termination can be carried out with SC, LC, ST type connectors and on request with special connectors.

Accessories supplied

The pre-termination of the cable includes:

- Full termination from both ends of the cable
- Optical connectors of the specified type
- Fan-out kit for the protection of the fibres
- Protection of the optical connectors with a special corrugated and reinforced thermoplastic tube with a diameter of 32 mm and a length of 70 cm
- Test report attached to the package

Terminal protection system



Recommendations for use

- The metal cone at the end of the protection tube has a hole which is useful for hanging the pulling system
- When laying the cable, it is important not to apply excessive strength, otherwise there is a risk of irreparable breakage of the optical fibres: maximum tensile force 100N
- Do not remove the cable during and after laying
- It is recommended lubricate the cable head and the duct before installation.
- The useful diameter of the conduit where the cable will be laid must be at least 50 mm

Removing the protection system

- Remove the two screws from the protection system.
- Pull the fibres carefully out of the protection tube, keeping the metal cone pointed towards the ground.

Description **PRE-TERMINATION OF OPTICAL CABLES**

Dimension of the protection tube

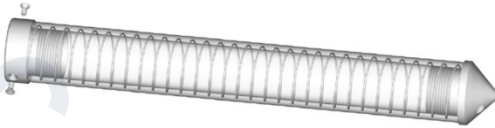

# fibres	Length	Diameter
4	590 mm	Ø 30 mm
6	640 mm	Ø 30 mm
8	690 mm	Ø 30 mm
12	790 mm	Ø 30 mm
24	940 mm	Ø 36 mm

Components of the protection system

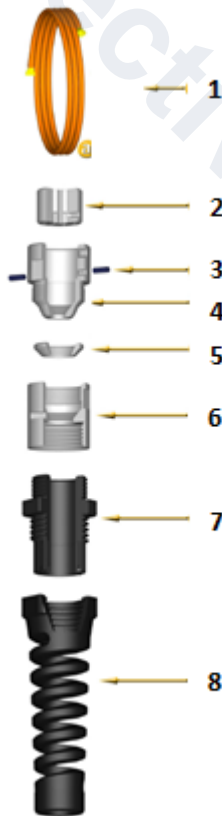

N.	Component	Material
1	2mm orange tube	LSZH - Kevlar - Hytrel
2	Drum	Aluminium
3	Pins	Steel
4	Front body	Aluminium
5	Conical nut	Aluminium
6	Rear body	Aluminium
7	Gland	Polyethylene
8	Prtection boot	Polyethylene

Ordering codes

Type of cable	N. fibres	ST connectors	SC connectors	LC connectors
Pre-termination on dielectric cable, LSZH jacket	4	2008210	2008220	2008240
	6	2008212	2008222	2008241
	8	2008211	2008221	2008242
	12	2008213	2008223	2008243
	24	2008214	2008224	2008244
Pre-termination on metallic armoured cable, PE jacket	6	2008216	2008226	2008246
	12	2008218	2008228	2008248
	24	2008219	2008229	2008249